



## BIMETAL THERMOMETERS

## T.W. SERIES BIMETAL THERMOMETER MODEL:TW 2010



### Applications:

2010 series bimetal thermometers are designed for light industry, HVAC use, especially for refrigeration and hot water.

### Specifications:

Dial size: 63, 80, 100mm

Case: zinc plated steel

Bezel: zinc plated steel bayonet bezel ring

Window: Glass

Bulb: copper alloy, adjustable at end

Pocket: brass, friction at axial of thermometer case, fixing by screw for option

Pocket length including thread: 50,63, 100, 150mm etc

Connection: 1/2" BSP bottom

### TEMPERATURE SENSOR:

Bimetal coil

## Ranges:

-40+40 deg C, -30+50 deg C, -20+60 deg C, 0-120 deg C, high temperature up to 600 deg C for option in stainless steel bulb and pocket for option

**Accuracy:** 2% of full scale

## Dimensions:

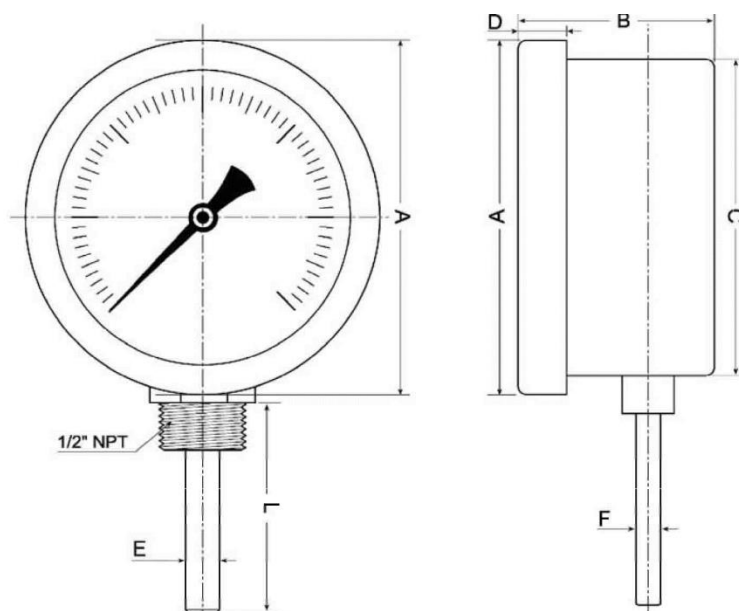

DIAL	A	B	C	D	E	F	L
2"	∅69	38	∅62	12	∅12	∅9	63/100
3"	∅85	48.5	∅75	14	∅12	∅9	63/100
4"	∅111	50	∅100	14	∅12	∅9	63/100